

XL 56b/58/59.

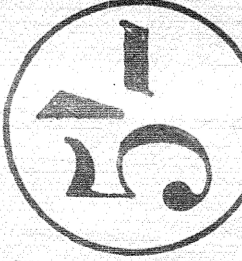

DESIGNED BY R. Cizek

COPYRIGHT OF THE AEROMODELLER PLANS SERVICE

38, CLARENDON RD., WATFORD HERTS.

ALL WOODS ARE Balsa UNLESS OTHERWISE STATED

3	STRIPS OF 1/4" X 1/8" Balsa
5	1 STRIP OF 1/8" X 3/32" SPRUCE BAMBINO
7	3" OF 3/16" DOWEL
3	3" X 3/32" DIA. BAMBINO
1	1/8" X 3" X 3"
1	1/16" X 3" X 3"
1	4"x2" OF 20 SWG ALUM.
2	BLOCKS OF 2" X 1/8" X 3/4"
1	1/4" SWG. BUSH AND THRUST RACE

COVER WHOLE MODEL WITH LIGHTWEIGHT MODELSPAN. GIVE FUSELAGE 3 COATS, WINGS & TAIL 2 COATS CLEAR DOPE

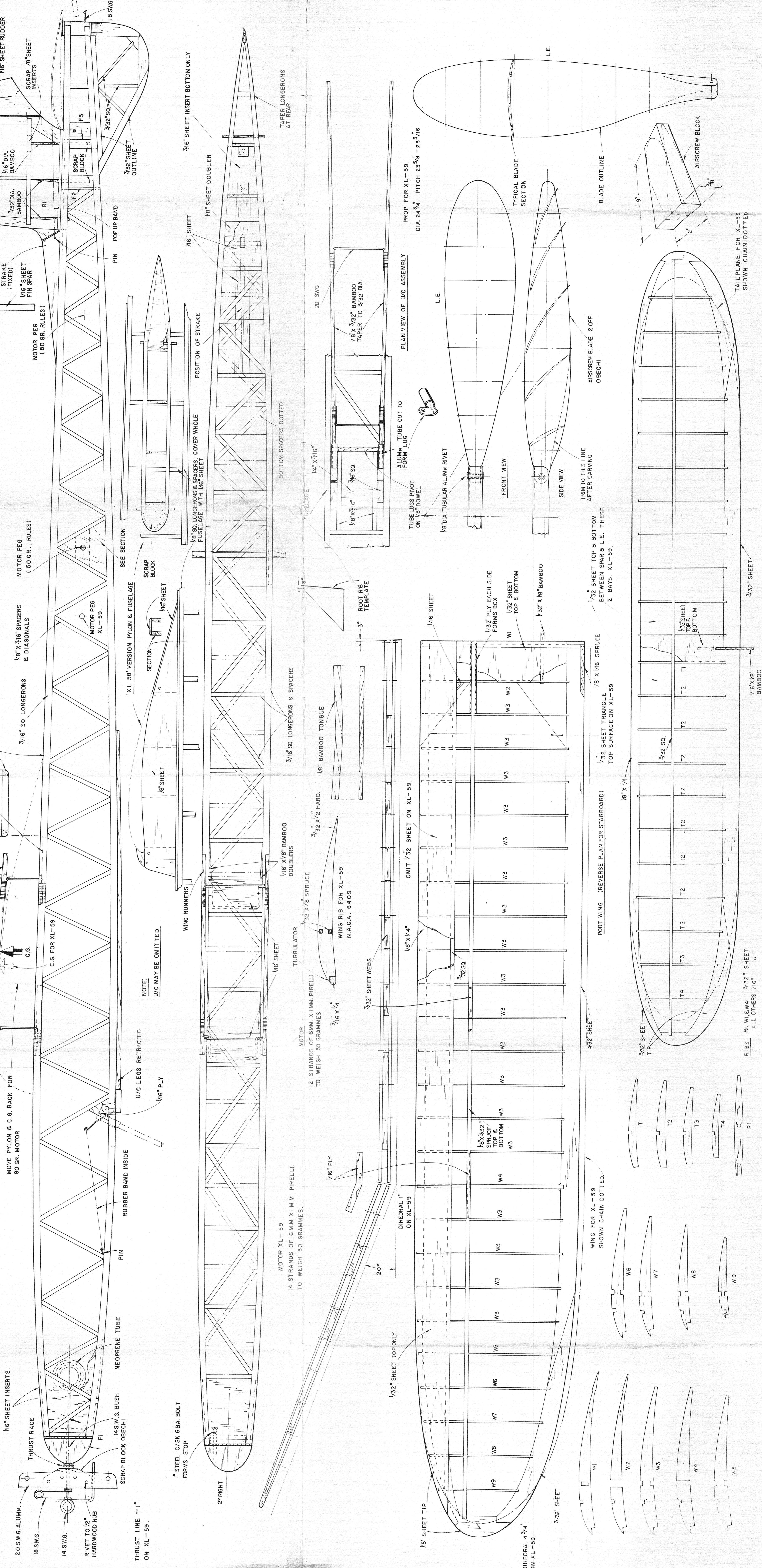

20 SWG ALUM. 18 SWG. 14 SWG. RIVET TO 1/2" HARDWOOD HUB

THRUST LINE - 1" ON XL-59

1" STEEL C/SK 6BA BOLT FORMS STOP

SCRAP BLOCK OBECHI

NEOPRENE TUBE

PIN

RUBBER BAND INSIDE

U/C LEGS RETRACTED

1/16" PLY

NOTE: U/C MAY BE OMITTED

1/8" X 3/16" BAMBINO

SECTION AT MOTOR PEG

RUBBER TUBE

MOTOR PEG

3/16" DIA BAMBINO

1/16" PLY

3/32" SHEET F3

1/16" PLY

F1 1/16" PLY

WING PYLON FOR XL-59 SHOWN DOTTED CONSTRUCTION AS FOR XL-58

MOVE PYLON & C.G. BACK FOR 80 GR. MOTOR

C.G. FOR XL-59

1/8" X 3/16" BAMBINO

SECTION AT MOTOR PEG

ROUND OFF CORNERS

3/16" SQ. LONGERONS & DIAGONALS

1/8" X 3/16" SPACERS

XL 56b/58/59. DESIGNED BY R. Cizek. COPYRIGHT OF THE AEROMODELLER PLANS SERVICE. 38, CLARENDON RD., WATFORD HERTS. ALL WOODS ARE Balsa UNLESS OTHERWISE STATED.